

*Update 2009*

**CONTI<sup>®</sup> BTT Hz**

Belt Tension Tester

Benutzerhandbuch

User Guide

Power Transmission Group



## ENTWICKLUNG 2008-2009

- ▶ **Zugefügte Marken, Modelle und Änderungen betreffend der Katalogausgabe 2008.**
  - ▶ *Brands, vehicle names and motorizations added compared to the catalogue published in 2008.*



Fahrzeug  
Vehicle



Merkmale  
Characteristics



Einstellspannungen  
Adjustment tension



T1 - Hz



T2 - Hz

Schema  
Diagram



### Alfa Romeo

Alfa Romeo						
<b>MiTo</b>						
1.4 TB 16V	199 A8 000	Distribution	04/2008		Auto	FLA-bd
<b>Spider</b>						
1.8i 16V	AR 322.01	Distribution ADE			Auto Auto	FLA-ac FLA-ad
2.0i 16V	AR 162.01	Distribution ADE			Auto Auto	FLA-ac FLA-ad
	AR 323.01	Distribution ADE			Auto Auto	FLA-ac FLA-ad
	AR 323.10	Distribution ADE			Auto Auto	FLA-ac FLA-ad
2.0 JTS 16V	937 A1 000	Distribution			Auto	FLA-ae
<b>145</b>						
1.8i 16V	AR 322.01	Distribution ADE			Auto Auto	FLA-ac FLA-ad
	AR 671.06	Distribution ADE			Auto Auto	FLA-ac FLA-ad
	AR 671.99	Distribution ADE			Auto Auto	FLA-ac FLA-ad
2.0i 16V	AR 323.01	Distribution ADE			Auto Auto	FLA-ac FLA-ad
	AR 672.04	Distribution ADE			Auto Auto	FLA-ac FLA-ad
	AR 672.99	Distribution ADE			Auto Auto	FLA-ac FLA-ad
1.9 TDs	AR 336.01	Distribution		75-81 2 75-81		FLA-be
	AR 675.01	Distribution		75-81 2 75-81		FLA-be
<b>146</b>						
1.8i 16V	AR 322.01	Distribution ADE			Auto Auto	FLA-ac FLA-ad
1.8i 16V	AR 671.06	Distribution ADE			Auto Auto	FLA-ac FLA-ad
2.0i 16V	AR 323.01	Distribution ADE			Auto Auto	FLA-ac FLA-ad
	AR 672.04	Distribution ADE			Auto Auto	FLA-ac FLA-ad

Fahrzeug  
Vehicle



Merkmale  
Characteristics



Einstellspannungen  
Adjustment tension



Schema  
Diagram



146	1.9 TDs	AR 336.01	Distribution	75-81	2	75-81	FLA-be
		AR 675.01	Distribution	75-81	2	75-81	FLA-be
<b>155</b>							
1.8i 16V	AR 671.06	Distribution ADE				Auto	FLA-ac
						Auto	FLA-ad
2.0i 16V	AR 672.04	Distribution ADE				Auto	FLA-ac
						Auto	FLA-ad
	AR 672.99	Distribution ADE				Auto	FLA-ac
						Auto	FLA-ad
1.9 TDs	AR 336.01	Distribution		75-81	2	75-81	FLA-be
			AR 675.01	Distribution	75-81	2	75-81
<b>GT</b>							
2.0 JTS 16V	932 A2 000	Distribution				Auto	FLA-ae
						Auto	FLA-ae
937 A1 000	Distribution					Auto	FLA-ae
							Auto
<b>156</b>							
1.8i 16V	AR 322.01	Distribution ADE				Auto	FLA-ac
						Auto	FLA-ad
2.0i 16V	AR 323.01	Distribution ADE				Auto	FLA-ac
						Auto	FLA-ad
	AR 323.10	Distribution ADE				Auto	FLA-ac
						Auto	FLA-ad
2.0 JTS 16V	932 A2 000	Distribution				Auto	FLA-ae
						Auto	FLA-ae
	937 A1 000	Distribution				Auto	FLA-ae
<b>166</b>							
2.0i 16V	AR 341.03	Distribution				Auto	FLA-ae
						Auto	FLA-ae
	AR 363.01	Distribution				Auto	FLA-ae
<b>GTV</b>							
1.8i 16V	AR 322.01	Distribution ADE				Auto	FLA-ac
						Auto	FLA-ad
2.0i 16V	AR 162.01	Distribution ADE				Auto	FLA-ac
						Auto	FLA-ad
2.0i 16V	AR 323.01	Distribution ADE				Auto	FLA-ac
						Auto	FLA-ad
	AR 323.10	Distribution ADE				Auto	FLA-ac
						Auto	FLA-ad
2.0 JTS 16V	937 A1 000	Distribution				Auto	FLA-ae

**Fahrzeug**  
Vehicle



**Merkmale**  
Characteristics



**Einstellspannungen**  
Adjustment tension



**Schema**  
Diagram



### Citroën

Citroën						
C1	1.0 12V	1KR	Distribution			Auto
	1.4 HDi	DV4TD	Distribution			Auto PSA-ar
C2	1.6 HDi 16V	DV6TED4	Distribution			Auto PSA-ap
C3	1.6 HDi 16	DV6TED4	Distribution			Auto PSA-ap
C5	1.6 HDi 16	DV6TED4	Distribution			Auto PSA-ap
Nemo	1.4 HDi	DV4TD	Distribution			Auto PSA-ar
Berlingo	1.6 HDi 16V	DV6TED4	Distribution			Auto PSA-ap

### Fiat

Fiat									
Cinquecento	1,1 ie	176 B2 000	Distribution (104)		> Mtr. 9 042 883	Σ = 90-115	2	Σ = 155-195	FLA-ba
			Distribution (125)		Mtr. 9 042 883 >	Σ = 90-115	2	Σ = 155-195	FLA-ba
Seicento	1,1 ie	176 B2 000	Distribution (104)		> Mtr. 9 042 883	Σ = 90-115	2	Σ = 155-195	FLA-ba
			Distribution (125)		Mtr. 9 042 883 >	Σ = 90-115	2	Σ = 155-195	FLA-ba
		187 A1 000	Distribution (104)		> Mtr. 9 042 883	Σ = 90-115	2	Σ = 155-195	FLA-ba
			Distribution (125)		> Mtr. 2 533 527	Σ = 90-115	2	Σ = 155-195	FLA-ba
			Distribution (125)		Mtr. 2 533 883 >			Auto	FLA-bc
500	1.2 i	169 A4 000	Distribution (129)	07/2007 ▶					Auto FLA-bd
	1.4 MPi 16V	169 A3 000	Distribution	07/2007 ▶					Auto FLA-bd

**Fahrzeug**  
Vehicle



**Merkmale**  
Characteristics



**Einstellspannungen**  
Adjustment tension



**Schema**  
Diagram



FIAT

Panda											
750	141 B 000	Distribution (104)						Σ = 90-115	2	Σ = 155-195	FLA-ba
	156 A4 000	Distribution (104)			> Mtr. 9 042 883			Σ = 90-115	2	Σ = 155-195	FLA-ba
		Distribution (125)			Mtr. 9 042 883 >			Σ = 90-115	2	Σ = 155-195	FLA-ba
	156 A4 048	Distribution (104)			> Mtr. 9 042 883			Σ = 90-115	2	Σ = 155-195	FLA-ba
		Distribution (125)			Mtr. 9 042 883 >			Σ = 90-115	2	Σ = 155-195	FLA-ba
900	141 C2 000	Distribution (104)			> Mtr. 9 042 883			Σ = 90-115	2	Σ = 155-195	FLA-ba
		Distribution (125)			Mtr. 9 042 883 >			Σ = 90-115	2	Σ = 155-195	FLA-ba
1,0	156 A2 000	Distribution (104)			> Mtr. 9 042 883			Σ = 90-115	2	Σ = 155-195	FLA-ba
		Distribution (125)			Mtr. 9 042 883 >			Σ = 90-115	2	Σ = 155-195	FLA-ba
	156 A2 100	Distribution (104)			> Mtr. 9 042 883			Σ = 90-115	2	Σ = 155-195	FLA-ba
		Distribution (125)			Mtr. 9 042 883 >			Σ = 90-115	2	Σ = 155-195	FLA-ba
1,0 ie	156 A2 246	Distribution (104)			> Mtr. 9 042 883			Σ = 90-115	2	Σ = 155-195	FLA-ba
		Distribution (125)			Mtr. 9 042 883 >			Σ = 90-115	2	Σ = 155-195	FLA-ba
	156 A3 000	Distribution (104)			> Mtr. 9 042 883			Σ = 90-115	2	Σ = 155-195	FLA-ba
		Distribution (125)			Mtr. 9 042 883 >			Σ = 90-115	2	Σ = 155-195	FLA-ba
	156 A3 100	Distribution (104)			> Mtr. 9 042 883			Σ = 90-115	2	Σ = 155-195	FLA-ba
		Distribution (125)			Mtr. 9 042 883 >			Σ = 90-115	2	Σ = 155-195	FLA-ba
1,1 ie	156 C 046	Distribution (104)			> Mtr. 9 042 883			Σ = 90-115	2	Σ = 155-195	FLA-ba
		Distribution (125)			Mtr. 9 042 883 >			Σ = 90-115	2	Σ = 155-195	FLA-ba
	176 B2 000	Distribution (104)			> Mtr. 9 042 883			Σ = 90-115	2	Σ = 155-195	FLA-ba
		Distribution (125)			Mtr. 9 042 883 >			Σ = 90-115	2	Σ = 155-195	FLA-ba
	187 A1 000	Distribution (104)	10/2000	▶ 08/2003	> Mtr. 9 042 883			Σ = 90-115	2	Σ = 155-195	FLA-ba
		Distribution (125)	10/2000	▶ 08/2003	Mtr. 9 042 884 >			Σ = 90-115	2	Σ = 155-195	FLA-ba
		Distribution (125)	09/2003	▶						Auto	FLA-bc
	1.2 i	Distribution (129)	09/2003	▶	> Mtr. 2 533 528			Σ = 95-120	2	Σ = 165-205	FLA-bb
		Distribution (129)	09/2003	▶	Mtr. 2 533 529 >					Auto	FLA-bd
Uno											
900	146 A0	Distribution								Chain	
1,0 ie	156 A2 000	Distribution (104)			> Mtr. 9 042 883			Σ = 90-115	2	Σ = 155-195	FLA-ba
		Distribution (125)			Mtr. 9 042 883 >			Σ = 90-115	2	Σ = 155-195	FLA-ba
	154 A2 044	Distribution (104)			> Mtr. 9 042 883			Σ = 90-115	2	Σ = 155-195	FLA-ba
		Distribution (125)			Mtr. 9 042 883 >			Σ = 90-115	2	Σ = 155-195	FLA-ba
	155 A2 045	Distribution (104)			> Mtr. 9 042 883			Σ = 90-115	2	Σ = 155-195	FLA-ba
		Distribution (125)			Mtr. 9 042 883 >			Σ = 90-115	2	Σ = 155-195	FLA-ba
	156 A2 048	Distribution (104)			> Mtr. 9 042 883			Σ = 90-115	2	Σ = 155-195	FLA-ba
		Distribution (125)			Mtr. 9 042 883 >			Σ = 90-115	2	Σ = 155-195	FLA-ba
	156 A2 100	Distribution (104)			> Mtr. 9 042 883			Σ = 90-115	2	Σ = 155-195	FLA-ba
		Distribution (125)			Mtr. 9 042 883 >			Σ = 90-115	2	Σ = 155-195	FLA-ba

### Fahrzeug Vehicle



### Merkmale Characteristics



### Einstellspannungen Adjustment tension



### Schema Diagram

Uno	1.0 ie	156 A2 246	Distribution (104)		> Mtr. 9 042 883	$\Sigma = 90-115$	2	$\Sigma = 155-195$	FLA-ba	
			Distribution (125)		Mtr. 9 042 883 >	$\Sigma = 90-115$	2	$\Sigma = 155-195$	FLA-ba	
	1,1	156 C 046	Distribution (104)		> Mtr. 9 042 883	$\Sigma = 90-115$	2	$\Sigma = 155-195$	FLA-ba	
			Distribution (125)		Mtr. 9 042 883 >	$\Sigma = 90-115$	2	$\Sigma = 155-195$	FLA-ba	
		146 A4 044	Distribution (104)		> Mtr. 9 042 883	$\Sigma = 90-115$	2	$\Sigma = 155-195$	FLA-ba	
		146 C3 000	Distribution (104)	01/1989 ▶ 09/1995	> Mtr. 9 042 883	$\Sigma = 90-115$	2	$\Sigma = 155-195$	FLA-ba	
			Distribution (125)		Mtr. 9 042 883 >	$\Sigma = 90-115$	2	$\Sigma = 155-195$	FLA-ba	
		160 A3 000	Distribution (104)	01/1989 ▶ 09/1995	> Mtr. 9 042 883	$\Sigma = 90-115$	2	$\Sigma = 155-195$	FLA-ba	
			Distribution (125)		Mtr. 9 042 883 >	$\Sigma = 90-115$	2	$\Sigma = 155-195$	FLA-ba	
		1,4	146 C2 028	Distribution			74-78	2	74-78	FLA-ai
		1,4 ie	146 A8 000	Distribution			74-78	2	74-78	FLA-ai
				Distribution			74-78	2	74-78	FLA-ai
			146 C1 000	Distribution			74-78	2	74-78	FLA-ai
			146 C1 046	Distribution			74-78	2	74-78	FLA-ai
		1,7 D	146 B2 000	Distribution			74-80	2	74-80	FLA-be
	Distribution			10/1985 ▶ 08/1995			74-80	2	74-80	FLA-be
<b>Tipo</b>										
	1,1	160 A3	Distribution (104)			$\Sigma = 90-115$	2	$\Sigma = 155-195$	FLA-ba	
			Distribution			74-78	2	74-78	FLA-ai	
	1,4	159 A2 000	Distribution			74-78	2	74-78	FLA-ai	
			836 A4 000	Distribution			74-78	2	74-78	FLA-ai
	1,6	159 A3 000	Distribution			74-78	2	74-78	FLA-ai	
			159 A3 048	Distribution			74-78	2	74-78	FLA-ai
	1,9 D	160 A7 000	Distribution	03/1993 ▶ 12/1995		75-81	2	75-81	FLA-be	
	1,9 TD	160 A6 000	Distribution	01/1988 ▶ 12/1995		75-81	2	75-81	FLA-be	
			Distribution	06/1990 ▶ 02/1993		75-81	2	75-81	FLA-be	
			Distribution	06/1990 ▶ 02/1993		75-81	2	75-81	FLA-be	
			Distribution	04/1993 ▶ 12/1995		75-81	2	75-81	FLA-be	
<b>Punto</b>										
	1.1	176 A6 000	Distribution (104)	1993 ▶ 1996		$\Sigma = 90-115$	2	$\Sigma = 155-195$	FLA-ba	
			Distribution (104)	1996 ▶	> Mtr. 9 042 883	$\Sigma = 90-115$	2	$\Sigma = 155-195$	FLA-ba	
			Distribution (125)	1996 ▶	Mtr. 9 042 883 >	$\Sigma = 90-115$	2	$\Sigma = 155-195$	FLA-ba	

## Fahrzeug Vehicle



## Merkmale Characteristics



## Einstellspannungen Adjustment tension



## Schema Diagram



Fahrzeug	Motor	Typ	Distribution	1993	1996	> Mtr. 9 042 883	Mtr. 9 042 883 >	Σ = 90-115	2	Σ = 155-195	FLA-ba
Punto	1.1	176 B2 000	Distribution (104)	1993	1996						
			Distribution (104)	1996							
			Distribution (125)	1996							
	1.4 i 16V	843 A1 000	Distribution	07/2003							Auto FLA-bd
	1,7 D	176 B3 000	Distribution	10/1994				74-80	2	74-80	FLA-be
	1.7 TD	176 A3 000	Distribution	07/1993	09/1999			74-80	2	74-80	FLA-be
		176 A5 000	Distribution	07/1993	09/1999			74-80	2	74-80	FLA-be
		176 B7 000	Distribution	06/1996	09/1999			74-80	2	74-80	FLA-be
<b>Grande Punto</b>											
	1.2 i	199 A4 000	Distribution (129)	10/2005							Auto FLA-bd
	1.4 MPi 16V	198 A4 000	Distribution	05/2007							Auto FLA-bd
		199 A6 000	Distribution	10/2005							Auto FLA-bd
	Abarth	199 A8 000	Distribution	09/2007							Auto FLA-bd
<b>Idea</b>											
	1.2 i 16V	188 A5 000	Distribution	02/2004	06/2007						Auto FLA-bd
	1.4 i 16V	192 B2 000	Distribution	10/2003	06/2007						Auto FLA-bd
		843 A1 000	Distribution	10/2003							Auto FLA-bd
<b>Stilo</b>											
	1.4 i 16V	192 B2 000	Distribution	01/2004							Auto FLA-bd
		843 A1 000	Distribution	01/2004							Auto FLA-bd
	1.6 16V	192 B3 000	Distribution	01/2004							Auto FLA-ag
<b>Brava</b>											
	1.2 16V	188 A5 000	Distribution	10/1998							Auto FLA-bd
	1.6 16V	182 B6 000	Distribution	10/1998							Auto FLA-ag
	1,9 D	160 A7 000	Distribution	06/1995	09/1998			75-81	2	75-81	FLA-be
<b>Bravo</b>											
	1.2 16V	188 A5 000	Distribution	10/1998							Auto FLA-bd
	1.6 16V	182 B6 000	Distribution	10/1998							Auto FLA-ag
	1,9 D	160 A7 000	Distribution	06/1995	09/1998			75-81	2	75-81	FLA-be
<b>Coupé</b>											
	1.8i 16V	183 A1 000	Distribution								Auto FLA-ae

### Fahrzeug Vehicle



### Merkmale Characteristics



### Einstellspannungen Adjustment tension



### Schema Diagram

Marea											
1.2 i 16V	182 B2 000	Distribution	02/1999	▶					Auto	FLA-bd	
1.6 16V	182 B5 098	Distribution	02/1999	▶					Auto	FLA-ag	
	182 B6 000	Distribution	02/1999	▶					Auto	FLA-ag	
	185 A3 000	Distribution	09/1999	▶					Auto	FLA-ag	
Siena											
1.2 i	178 B5 000	Distribution (108)	09/1998	▶	12/2001	> Mtr. 9 042 883	Σ = 95-120	2	Σ = 165-205	FLA-bb	
		Distribution (129)	09/1998	▶	12/2001	Mtr. 9 042 884 >	Σ = 95-120	2	Σ = 165-205	FLA-bb	
	178 B7 045	Distribution (108)	06/1999	▶	12/2001	> Mtr. 9 042 883	Σ = 95-120	2	Σ = 165-205	FLA-bb	
		Distribution (129)	09/1998	▶	12/2001	Mtr. 9 042 884 >	Σ = 95-120	2	Σ = 165-205	FLA-bb	
	178 C4 066	Distribution (108)	06/1999	▶		> Mtr. 9 042 883	Σ = 95-120	2	Σ = 165-205	FLA-bb	
		Distribution (129)	09/1998	▶	12/2001	Mtr. 9 042 884 >	Σ = 95-120	2	Σ = 165-205	FLA-bb	
	188 A4 000	Distribution (129)	01/2002	▶			Σ = 95-120	2	Σ = 165-205	FLA-bb	
1.2 i 16V	178 D7 055	Distribution	01/2002	▶					Auto	FLA-bd	
			188 A5 000	Distribution	01/2002	▶				Auto	FLA-bd
1.6 i 16V	178 D2 011	Distribution	06/1999	▶	12/2001				Auto	FLA-ag	
		178 B3 000	Distribution	11/1997	▶	12/2001				Auto	FLA-ag
			Distribution	09/1998	▶	12/2001				Auto	FLA-ag
			Distribution	01/2002	▶					Auto	FLA-ag
1.7 D	176 B3 000	Distribution	09/1998	▶	12/2001		74-80	2	74-80	FLA-be	
1.7 TD	176 B7 000	Distribution	06/1999	▶	12/2001			74-80	2	74-80	FLA-be
		Distribution	09/1999	▶	12/2001			74-80	2	74-80	FLA-be
Albea											
1.2 i	188 A4 000	Distribution (129)	04/2002	▶			Σ = 95-120	2	Σ = 165-205	FLA-bb	
1.2 i 16V	188 A5 000	Distribution	04/2002	▶					Auto	FLA-bd	
1.6 i 16V	182 B6 000	Distribution	04/2002	▶					Auto	FLA-ag	
Palio											
1.1	178 B9 033	Distribution (104)				> Mtr. 9 042 883	Σ = 90-115	2	Σ = 155-195	FLA-ba	
		Distribution (125)				Mtr. 9 042 883 >	Σ = 90-115	2	Σ = 155-195	FLA-ba	
1.2	178 E2 000	Distribution (108)	07/1997	▶		> Mtr. 9 042 883	Σ = 95-120	2	Σ = 165-205	FLA-bb	
		Distribution (129)	07/1997	▶		Mtr. 9 042 884 >	Σ = 95-120	2	Σ = 165-205	FLA-bb	
	178 B7 045	Distribution (108)	06/1999	▶	02/2001	> Mtr. 9 042 883	Σ = 95-120	2	Σ = 165-205	FLA-bb	
		Distribution (129)	06/1999	▶	02/2001	Mtr. 9 042 884 >	Σ = 95-120	2	Σ = 165-205	FLA-bb	

**Fahrzeug**  
Vehicle



**Merkmale**  
Characteristics



**Einstellspannungen**  
Adjustment tension



**Schema**  
Diagram



Fahrzeug	Motor	Typ	Distribution	Datum	Merkmale	Einstellspannungen	Schema		
Palio	1.2 i	188 A4 000	Distribution (129)	09/1997	> Mtr. 2 533 528 Mtr. 2 533 529 >	Σ = 95-120 2	Σ = 165-205 FLA-bb		
			Distribution (129)	09/2000			Σ = 165-205 FLA-bd		
		178 C4 066	Distribution (129)	03/2001		Σ = 95-120 2	Σ = 165-205 FLA-bb		
	1.2 i 16V	178 D7 055	Distribution	03/2001			Auto	FLA-bd	
		188 A5 000	Distribution	03/2001			Auto	FLA-bd	
	1.6 16V	178 D2 011	Distribution	11/1999	02/2001			Auto	FLA-ag
		182 B6 000	Distribution	09/1997				Auto	FLA-ag
		178 E7 000	Distribution	03/2001				Auto	FLA-ag
	1,7 TD	176 A3 000	Distribution	09/1997	02/2001		74-80 2	74-80	FLA-be
		176 B7 000	Distribution	06/1999	12/2001		74-80 2	74-80	FLA-be
		178 C9 066	Distribution	09/1997	02/2001		74-80 2	74-80	FLA-be
		176 B3 000	Distribution	09/1998	02/2001		74-80 2	74-80	FLA-be
<b>Tempra</b>									
1.4 ie	159 A2 000	Distribution	10/1989	08/1996		74-78 2	74-78	FLA-ai	
	836 A4 000	Distribution	03/1992	08/1996		74-78 2	74-78	FLA-ai	
1.4 ie	160 A1 046	Distribution	04/1990	08/1996		74-78 2	74-78	FLA-ai	
1.6 ie	159 A3 046	Distribution	06/1990	08/1996		74-78 2	74-78	FLA-ai	
	159 B9 000	Distribution	06/1994	08/1996		74-78 2	74-78	FLA-ai	
	835 C1 000	Distribution	06/1990	08/1996		74-78 2	74-78	FLA-ai	
	159 A3 000	Distribution	04/1990	08/1996		74-78 2	74-78	FLA-ai	
	159 A3 048	Distribution	11/1989	12/1996		74-78 2	74-78	FLA-ai	
1.9 D	160 A7 000	Distribution	11/1989	12/1996		75-81 2	75-81	FLA-be	
1.9 TD	160 A6 000	Distribution	04/1990	12/1996		75-81 2	75-81	FLA-be	
	160 A6 046	Distribution	11/1989	02/1993		75-81 2	75-81	FLA-be	
	160 B6 046	Distribution	04/1990	02/1993		75-81 2	75-81	FLA-be	
	160 D1 000	Distribution	03/1993	12/1996		75-81 2	75-81	FLA-be	
<b>Strada</b>									
1.2 i	178 B5 000	Distribution (108)	03/1999	03/2003	> Mtr. 9 042 883 Mtr. 9 042 884 >	Σ = 95-120 2	Σ = 165-205 FLA-bb		
		Distribution (129)	03/1999	03/2003			Σ = 95-120 2	Σ = 165-205 FLA-bb	
	188 A4 000	Distribution (129)	03/2003	05/2006		Σ = 95-120 2	Σ = 165-205 FLA-bb		
1.7 TDs	176 A3 000	Distribution	03/1999	03/2003		74-80 2	74-80	FLA-be	

**Fahrzeug**  
Vehicle



**Merkmale**  
Characteristics



**Einstellspannungen**  
Adjustment tension



**Schema**  
Diagram



Linea										
1.4 Tjet 16V	198 A4 000	Distribution	07/2007	▶					Auto	FLA-bd
Fiorino										
1.4 ie	146 C5 000	Distribution	08/1993	▶	05/2001	74-78	2	74-78		FLA-ai
	146 D5 000	Distribution	05/1994	▶	05/2001	74-78	2	74-78		FLA-ai
1.6 ie	146 C6 000	Distribution	08/1993	▶	05/2001	74-78	2	74-78		FLA-ai
1.6 ie	146 D6 000	Distribution	08/1993	▶	05/2001	74-78	2	74-78		FLA-ai
1.7 D	146 B2 000	Distribution	07/1990	▶	09/2000	74-80	2	74-80		FLA-be
	149 B3 000	Distribution	03/1988	▶	06/1990	74-80	2	74-80		FLA-be
	149 B4 046	Distribution	07/1990	▶	06/1993	74-80	2	74-80		FLA-be
1.7 TDs	146 D7 000	Distribution	06/1996	▶	09/2000	74-80	2	74-80		FLA-be
Scudo										
1.6	220 A2 000	Distribution		▶		74-78	2	74-78		FLA-ai
Doblo										
1,2 I	223 A5 000	Distribution (129)	10/2000	▶	12/2005	Σ = 95-120	2	Σ = 165-205		FLA-bb
Ford										
Fiesta										
1.6 TDCi 16V	HHJ A/B	Distribution							Auto	FOR-z
Fusion										
1.6 TDCi 16V	HHJ A/B	Distribution							Auto	FOR-z
Focus										
1.6 TDCi 16V	HHJ A/B	Distribution							Auto	FOR-z

FIAT - FORD

Fahrzeug  
Vehicle



Merkmale  
Characteristics



Einstellspannungen  
Adjustment tension



Schema  
Diagram



LANCIA

## Lancia

Y										
1.1	176 B2 000	Distribution (104)	09/1995	►	09/2003	> Mtr. 9 042 882	Σ = 90-115	2	Σ = 155-195	FLA-ba
1,2 16V	176 B9 000	Distribution	04/1997	►	08/2000				Auto	FLA-bd
	188 A5 000	Distribution	09/2000	►	09/2003				Auto	FLA-bd
<b>Y10</b>										
1,0	156 A2.000	Distribution (104)	05/1985	►	08/1995		Σ = 90-115	2	Σ = 155-195	FLA-ba
	156 A2.100	Distribution (104)	05/1985	►	08/1995		Σ = 90-115	2	Σ = 155-195	FLA-ba
	156 A2.246	Distribution (104)	05/1985	►	08/1995		Σ = 90-115	2	Σ = 155-195	FLA-ba
1.1	156 C 000	Distribution (104)	07/1989	►	08/1995		Σ = 90-115	2	Σ = 155-195	FLA-ba
	156 C.046	Distribution (104)	07/1989	►	08/1995		Σ = 90-115	2	Σ = 155-195	FLA-ba
	176 B2 000	Distribution (104) Distribution (125)	01/1995	►	12/1995	Mtr. 9 042 883 >	Σ = 90-115 Σ = 90-115	2 2	Σ = 155-195 Σ = 155-195	FLA-ba FLA-ba
<b>Ypsilon</b>										
1.2 i	188 A4 000	Distribution (129) Distribution (129)	10/2003	►		> Mtr. 2 533 528 Mtr. 2 533 529 >	Σ = 95-120	2	Σ = 165-205	FLA-bb FLA-bd
1.2 i 16V	188 A5 000	Distribution	10/2003	►					Auto	FLA-bd
1.4 i 16V	843 A1 000	Distribution	10/2003	►					Auto	FLA-bd
<b>Musa</b>										
1.4 i 16V	192 B2 000	Distribution	01/2006	►	09/2007				Auto	FLA-bd
	843 A1 000	Distribution	07/2004	►	09/2007				Auto	FLA-bd
<b>Lybra</b>										
1,6 16V	182 A4 000	Distribution	09/1999	►	12/2005				Auto	FLA-ag
	182 B6 000	Distribution	09/1999	►	12/2005				Auto	FLA-ag
1,8i 16V	839 A4 000	Distribution	09/1999	►	12/2006				Auto	FLA-ae
	839 A7 000	Distribution	09/1999	►	12/2006				Auto	FLA-ae
	839 A9 000	Distribution	09/1999	►	12/2006				Auto	FLA-ae
<b>Delta</b>										
1.4	836 A4 000	Distribution					74-78	2	74-78	FLA-ai
1.6 16V	182 A4 000	Distribution	07/1995	►	08/1999				Auto	FLA-ag
1.8i 16V	182 A2 000	Distribution	07/1995	►	08/1999				Auto	FLA-ae
	183 A1 000	Distribution	05/1996	►	08/1999				Auto	FLA-ae

### Fahrzeug Vehicle



### Merkmale Characteristics



### Einstellspannungen Adjustment tension



### Schema Diagram

Delta							
1.9 Td	160 D1 000	Distribution				75-81	2 75-81 FLA-be
	835 A4 000	Distribution				75-81	2 75-81 FLA-be
Dedra							
1.6 ie	159 B9 000	Distribution				74-78	2 74-78 FLA-ai
	835 A1 000	Distribution				74-78	2 74-78 FLA-ai
	835 A1 046	Distribution				74-78	2 74-78 FLA-ai
	835 C1 000	Distribution				74-78	2 74-78 FLA-ai
1.6 16V	182 A4 000	Distribution	12/1997	►	09/1999		Auto FLA-ag
		Alt.+WVP				180-210	225-245 FLA-d
		PAS				210-235	260-290 FLA-e
		AC				120-135	150-170 FLA-t
1.8i 16V	182 A2 000	Distribution	03/1996	►	09/1999		Auto FLA-ae
	183 A1 000	Distribution	03/1996	►	09/1999		Auto FLA-ae
1.9 Td	160 D1 000	Distribution				75-81	2 75-81 FLA-be
	835 A4 000	Distribution				75-81	2 75-81 FLA-be

## Nissan

Note							
1.5 dCi	K9K	Distribution					Auto NIS-r
		Alt.+TR				(5V) ⊕ V	223-245 NIS-u
		Alt.+AC				(5V) ⊕ V	Auto NIS-t
		Alt.+AC				(6V)	Auto NIS-t

Primera							
1.9 dCi	F9Q 200	Distribution				Mot. 1543 11 N.m	▼ 87-93 4 ▼ 85-95 NIS-q
	F9Q 204	Distribution				Mot. 1543 11 N.m	▼ 87-93 4 ▼ 85-95 NIS-q
	F9Q 260	Distribution				Mot. 1543 11 N.m	▼ 87-93 4 ▼ 75-81 NIS-q
	F9Q 264	Distribution				Mot. 1543 11 N.m	▼ 87-93 4 ▼ 75-81 NIS-q
	F9Q 266	Distribution				Mot. 1543 11 N.m	▼ 87-93 4 ▼ 75-81 NIS-q
	F9Q 268	Distribution					Auto NIS-r
	F9Q 270	Distribution				Mot. 1543 11 N.m	▼ 87-93 4 ▼ 75-81 NIS-q
	F9Q 650	Distribution				Mot. 1543 11 N.m	▼ 87-93 4 ▼ 85-95 NIS-q
	F9Q 664	Distribution				Mot. 1543 11 N.m	▼ 87-93 4 ▼ 75-81 NIS-q
	F9Q 670	Distribution				Mot. 1543 11 N.m	▼ 87-93 4 ▼ 85-95 NIS-q
	F9Q 674	Distribution				Mot. 1543 11 N.m	▼ 87-93 4 ▼ 75-81 NIS-q
	F9Q 710	Distribution			►	Mot. 1543 11 N.m	▼ 65-71 4 ▼ 56-66 NIS-o
	F9Q 710	Distribution	10/2001	►			Auto NIS-s
	F9Q 716	Distribution				Mot. 1543 11 N.m	▼ 65-71 4 ▼ 56-66 NIS-o
	F9Q 717	Distribution					Auto NIS-s
	F9Q 718	Distribution				Mot. 1543 11 N.m	▼ 87-93 4 ▼ 85-95 NIS-q
	F9Q 722	Distribution			►	Mot. 1543 11 N.m	▼ 65-71 4 ▼ 56-66 NIS-o
	F9Q 722	Distribution	10/2001	►			Auto NIS-s
	F9Q 730	Distribution				Mot. 1543 11 N.m	▼ 65-71 4 ▼ 56-66 NIS-o
	F9Q 731	Distribution					Auto NIS-s
	F9Q 732	Distribution				Mot. 1543 11 N.m	▼ 64-70 4 ▼ 62-72 NIS-o

## Fahrzeug Vehicle



## Merkmale Characteristics



## Einstellspannungen Adjustment tension



## Schema Diagram



NISSAN

Fahrzeug	Motor	Merkmale	Einstellspannungen	Schema
Primera 1.9 dCi	F9Q 733	Distribution	Mot. 1543 11 N.m ▼ 64-70 4 ▼ 62-72	NIS-o
	F9Q 734	Distribution	Mot. 1543 11 N.m ▼ 65-71 4 ▼ 56-66	NIS-o
	F9Q 736	Distribution	Mot. 1543 11 N.m ▼ 65-71 4 ▼ 56-66	NIS-o
	F9Q 736	Distribution	10/2001 ▶ 10/2001 Auto	NIS-s
	F9Q 738	Distribution	Mot. 1543 11 N.m ▼ 64-70 4 ▼ 62-72	NIS-o
	F9Q 740	Distribution	Mot. 1543 11 N.m ▼ 64-70 4 ▼ 62-72	NIS-o
	F9Q 744	Distribution	Auto	NIS-s
	F9Q 748	Distribution	Mot. 1543 11 N.m ▼ 64-70 4 ▼ 62-72	NIS-o
	F9Q 750	Distribution	Mot. 1543 11 N.m ▼ 87-93 4 ▼ 85-95	NIS-q
	F9Q 752	Distribution	Mot. 1543 11 N.m ▼ 87-93 4 ▼ 85-95	NIS-q
	F9Q 754	Distribution	Mot. 1543 11 N.m ▼ 87-93 4 ▼ 85-95	NIS-q
	F9Q 758	Distribution	Mot. 1543 11 N.m ▼ 87-93 4 ▼ 75-81	NIS-q
	F9Q 759	Distribution	Mot. 1543 11 N.m ▼ 87-93 4 ▼ 75-81	NIS-q
	F9Q 760	Distribution	Mot. 1543 11 N.m ▼ 87-93 4 ▼ 85-95	NIS-q
	F9Q 762	Distribution	Mot. 1543 11 N.m ▼ 87-93 4 ▼ 85-95	NIS-q
	F9Q 770	Distribution	Auto	NIS-s
	F9Q 772	Distribution	Mot. 1543 11 N.m ▼ 87-93 4 ▼ 85-95	NIS-q
	F9Q 774	Distribution	Mot. 1543 11 N.m ▼ 87-93 4 ▼ 85-95	NIS-q
	F9Q 780	Distribution	Auto	NIS-s
	F9Q 782	Distribution	Auto	NIS-s
	F9Q 790	Distribution	Mot. 1543 11 N.m ▼ 64-70 4 ▼ 62-72	NIS-o
	F9Q 796	Distribution	Mot. 1543 11 N.m ▼ 64-70 4 ▼ 62-72	NIS-o
	F9Q 800	Distribution	Mot. 1543 11 N.m ▼ 87-93 4 ▼ 75-81	NIS-q
	F9Q 803	Distribution	Mot. 1543 11 N.m ▼ 87-93 4 ▼ 75-81	NIS-q
	F9Q 804	Distribution	Mot. 1543 11 N.m ▼ 87-93 4 ▼ 75-81	NIS-q
	F9Q 808	Distribution	Mot. 1543 11 N.m ▼ 87-93 4 ▼ 75-81	NIS-q
	F9Q 812	Distribution	Mot. 1543 11 N.m ▼ 87-93 4 ▼ 75-81	NIS-q
	F9Q 816	Distribution	Mot. 1543 11 N.m ▼ 87-93 4 ▼ 75-81	NIS-q
	F9Q 818	Distribution	Mot. 1543 11 N.m ▼ 87-93 4 ▼ 75-81	NIS-q
	F9Q 820	Distribution	Mot. 1543 11 N.m ▼ 87-93 4 ▼ 85-95	NIS-q
F9Q 870	Distribution	Auto	NIS-r	
F9Q 872	Distribution	Auto	NIS-r	
F9Q 874	Distribution	Auto	NIS-r	
	Alt.+WP+PAS	146-154	183-193	NIS-j
	Alt.+AC		Auto	NIS-k
	Alt.+WP+AC	146-154	183-193	NIS-p
	Alt.+PAS+AC		Auto	NIS-l
	Alt.+WP+PAS+AC		Auto	NIS-n
<b>Tiida</b>				
1.5 dCi	K9K	Distribution	Auto	NIS-r
		Alt.+TR	(5V) ⊕ V	223-245
		Alt.+AC	(5V) ⊕ V	Auto
		Alt.+AC	(6V)	Auto
<b>Qashqai</b>				
1.5 dCi	K9K	Distribution	Auto	NIS-r
		Alt.+TR	(5V) ⊕ V	223-245
		Alt.+AC	(5V) ⊕ V	Auto
		Alt.+AC	(6V)	Auto
<b>Kubistar</b>				
1.2 e	D7F	Distribution	Mot. 1386 10 N.m ▼140-150 4 ▼140-150	NIS-ah
		Alt.	(4V) New 239-249 2 239-249	NIS-ac
		PAS	(5V) New 172-182 2 172-182	NIS-x
		AC	(5V) New 186-196 2 186-196	NIS-ad
		Alt.+AC	New 272-292 3 272-292	NIS-af
		PAS+AC	New 175-185 2 175-185	NIS-ae

**Fahrzeug**  
Vehicle



**Merkmale**  
Characteristics



**Einstellspannungen**  
Adjustment tension



**Schema**  
Diagram



Kubistar	1.2 16V e	D4F	Distribution		Auto	NIS-ai
			Alt.	New	272-282	3 272-282 NIS-w
			Alt.	New	255-265	3 255-265 NIS-ac
			PAS	(5V) New	205-215	3 205-215 NIS-x
			AC	(5V) New	205-215	3 205-215 NIS-ad
			Alt.+AC	New	272-292	3 272-292 NIS-af
			PAS+AC	New	205-215	3 205-215 NIS-ae
	<b>1.4 e</b>	<b>K7J</b>	<b>Distribution</b>	<b>Mot. 1501 10 N.m</b>	<b>▼157-167</b>	<b>4 ▼157-167 NIS-ag</b>
			Alt.	K7J 710 New	2	300-310 NIS-v
			AC	K7J 710 New		Elastique NIS-aa
			Alt.+TR	(5V) $\Phi$ V New	2	200-208 NIS-y
			Alt.+PAS	(5V) $\Phi$ V New	2	200-208 NIS-y
			Alt.+PAS+AC	$\Phi$ V New		Auto NIS-z
<b>Peugeot</b>						
<b>107</b>	<b>1.4 HDi</b>	<b>DV4TD</b>	<b>Distribution</b>			<b>Auto PSA-ar</b>
<b>1007</b>	<b>1.6 HDi 16</b>	<b>DV6TED4</b>	<b>Distribution</b>			<b>Auto PSA-ap</b>
<b>207</b>	<b>1.4 HDi</b>	<b>DV4TD</b>	<b>Distribution</b>			<b>Auto PSA-ar</b>
	<b>1.6 HDi 16</b>	<b>DV6TED4</b>	<b>Distribution</b>			<b>Auto PSA-ap</b>
<b>308</b>	<b>1,6 HDi 16V</b>	<b>DV6TED4</b>	<b>Distribution</b>			<b>Auto PSA-ap</b>
<b>Biipper</b>	<b>1.4 HDi</b>	<b>DV4TD</b>	<b>Distribution</b>			<b>Auto PSA-ar</b>
<b>Partner</b>	<b>1.6 HDi 16</b>	<b>DV6TED4</b>	<b>Distribution</b>			<b>Auto PSA-ap</b>
<b>Ranch</b>	<b>1.6 HDi 16</b>	<b>DV6TED4</b>	<b>Distribution</b>			<b>Auto PSA-ap</b>
<b>Expert</b>	<b>1.6 HDi 16</b>	<b>DV6TED4</b>	<b>Distribution</b>			<b>Auto PSA-ap</b>



**Fahrzeug**  
Vehicle



**Merkmale**  
Characteristics



**Einstellspannungen**  
Adjustment tension



**Schema**  
Diagram

Volvo									
<b>340</b>									
1.7	B172	Distribution	Mot. 1543 11 N.m	▼88-94	4	▼77-87	VOL-a		
		Alt.+WP	(5V) New		2	167-177	VOL-b		
		Alt.+WP	(6V) New		2	115-125	VOL-b		
		Alt.+WP+PAS	(6V) New		2	145-155	VOL-c		
		Alt.+WP+AC	(6V) New		2	125-135	VOL-d		
		Alt.+WP+PAS+AC	(6V) New		2	138-148	VOL-h		
1.6 d	D16	Distribution	Mot. 1543 11 N.m	▼65-71	4	▼56-66	VOL-e		
		Alt.+WP	(5V) New		2	156-166	VOL-b		
		Alt.+WP	(6V) New		2	156-166	VOL-b		
		Alt.+WP+PAS	(6V) New		2	160-170	VOL-c		
<b>360</b>									
1.6 d	D16	Distribution	Mot. 1543 11 N.m	▼65-71	4	▼56-66	VOL-e		
		Alt.+WP	(5V) New		2	156-166	VOL-b		
		Alt.+WP	(6V) New		2	156-166	VOL-b		
		Alt.+WP+PAS	(6V) New		2	160-170	VOL-c		
<b>XC70</b>									
2.0i 20V	B5204T3	Distribution	> Mtr. 1 266 127			Auto *94-104	VOL-g		
		Distribution	Mtr. 1 266 128 >			Auto *94-104	VOL-g		
2.4i 20V	B5244T	Distribution	> Mtr. 1 266 127			Auto *94-104	VOL-g		
		Distribution	Mtr. 1 266 128 >			Auto *94-104	VOL-g		
2.5i 20V	B5254T	Distribution	> Mtr. 1 266 127			Auto *94-104	VOL-g		
		Distribution	Mtr. 1 266 128 >			Auto *94-104	VOL-g		

VOLVO



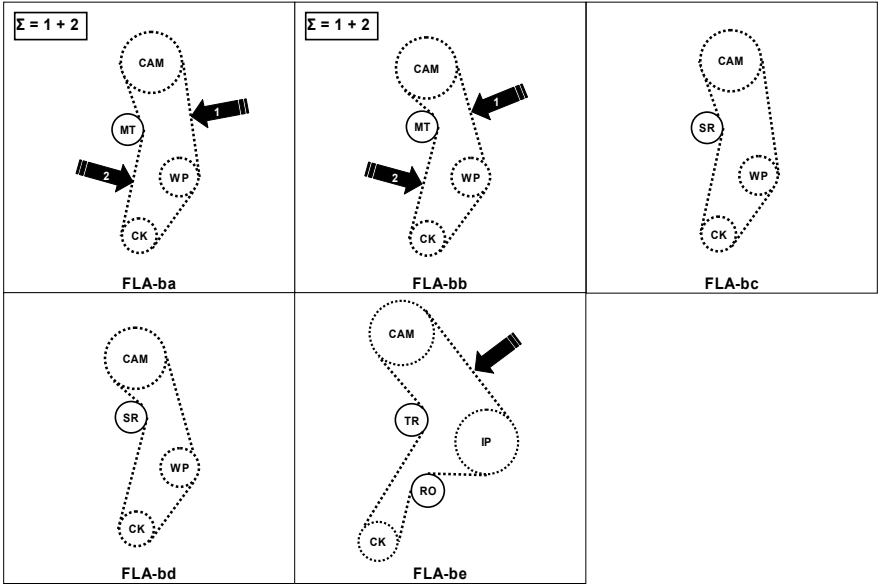

FIAT - LANCIA - ALFA ROMEO

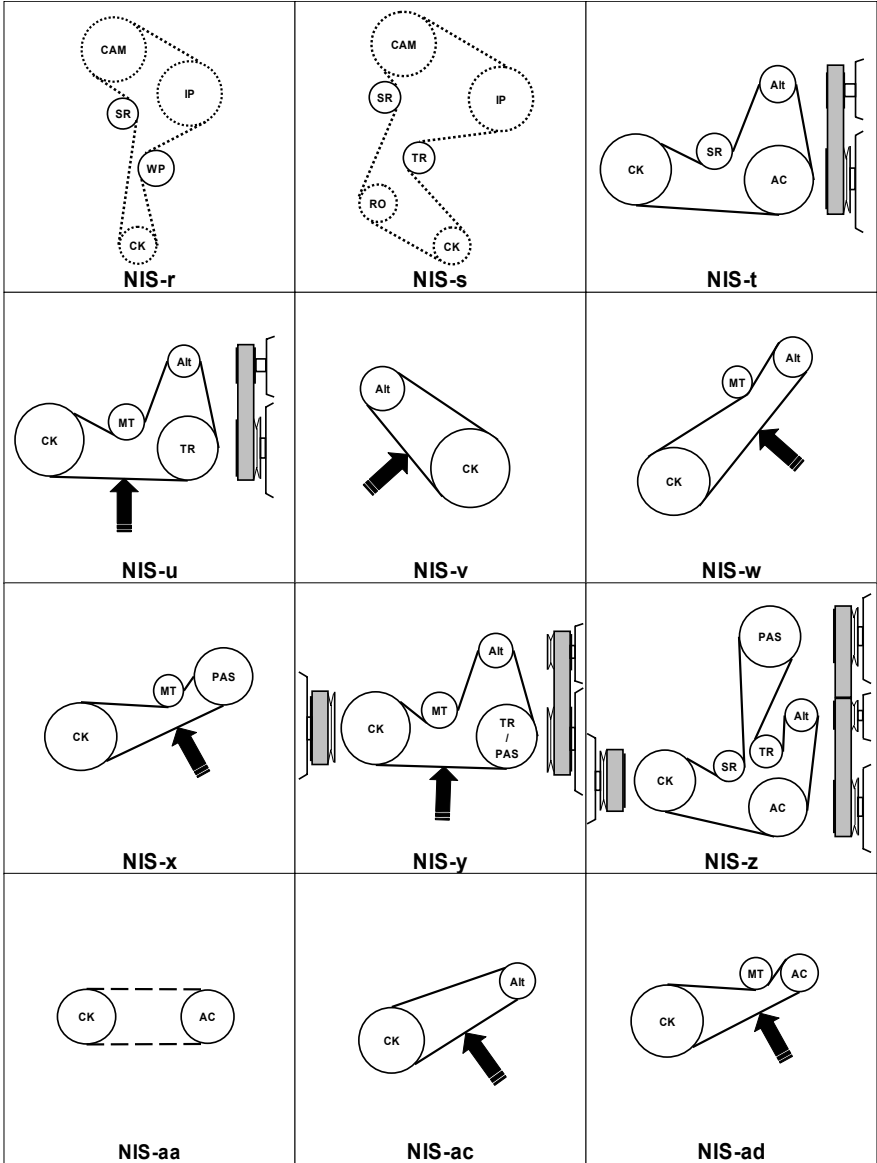

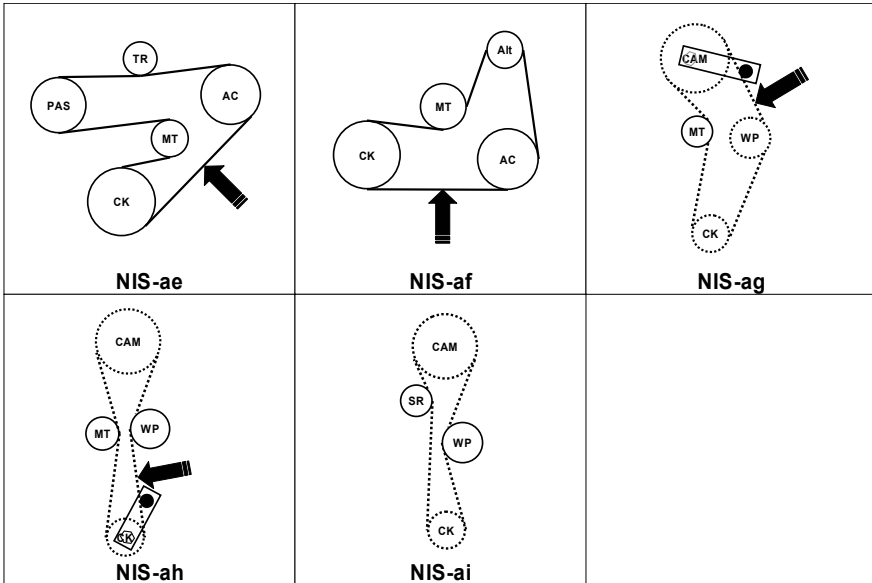

**NISSAN**

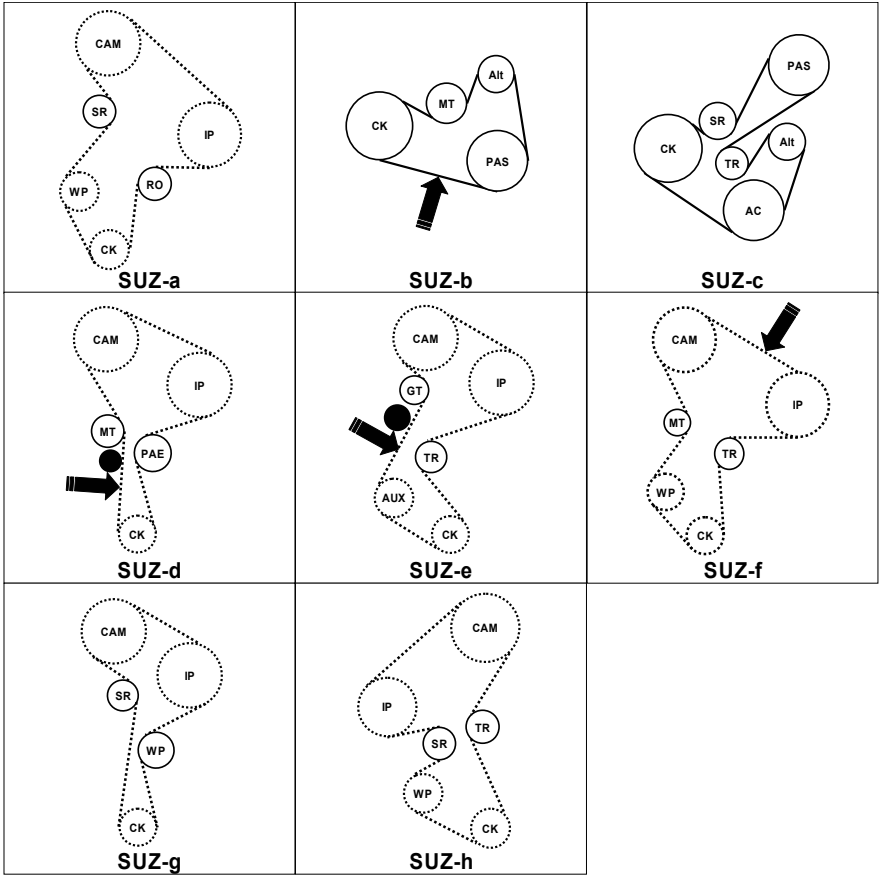

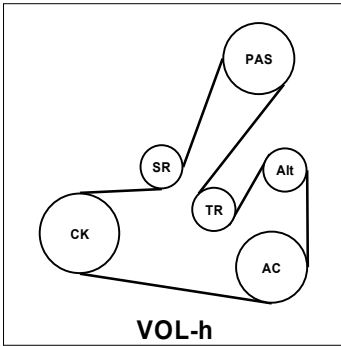

**VOLVO**